

— ADJOINING SITE OWNED BY APPLICANT
— APPLICATION SITE BOUNDARY

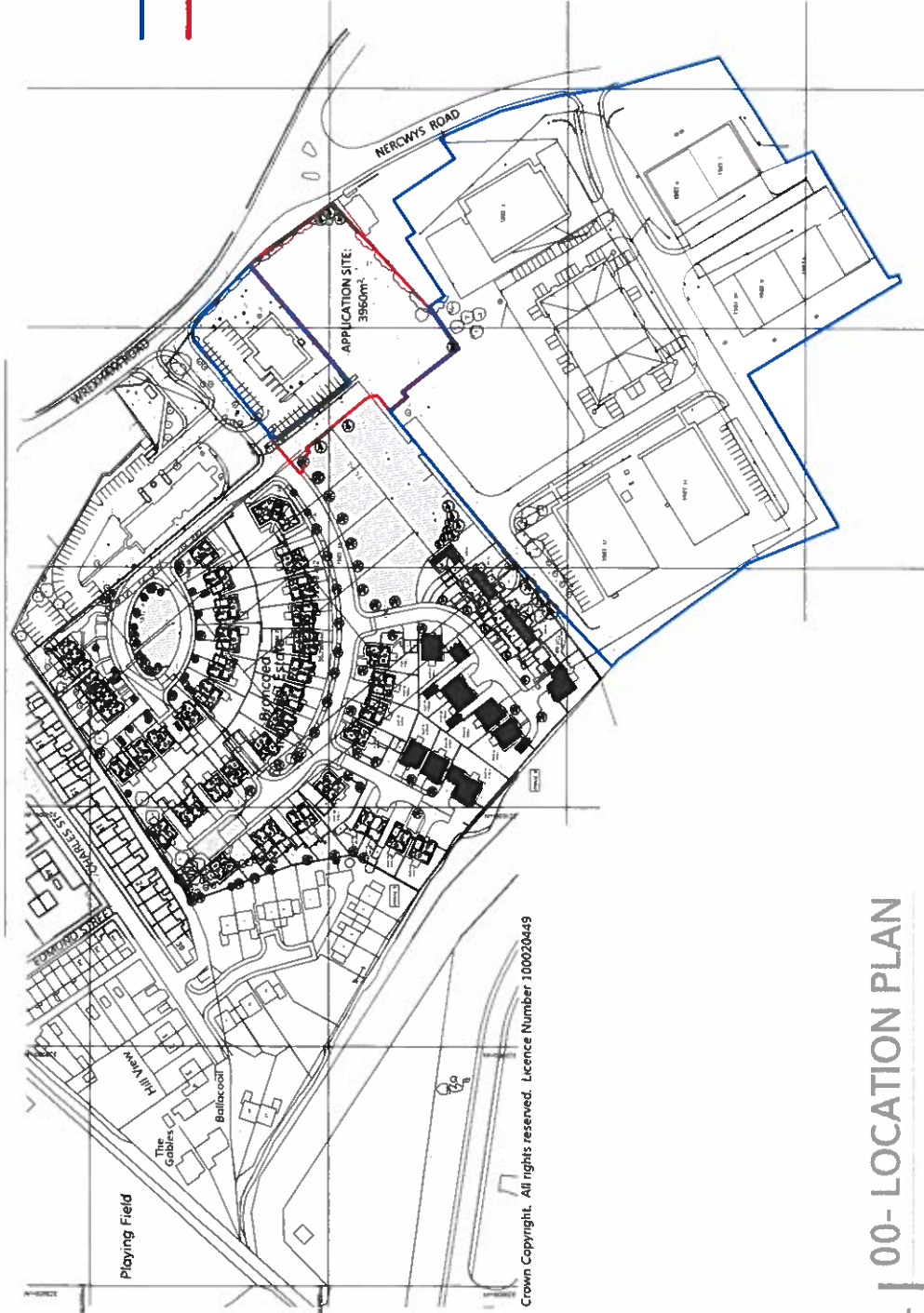

Crown Copyright. All rights reserved. Licence Number 100020449

1 | 00- LOCATION PLAN

SCALE: 1 : 2000

REV	DESCRIPTION	DATE	BY

THIS DRAWING IS THE COPYRIGHT OF AINSLEY COMMON ARCHITECTS. IT IS TO BE USED ONLY FOR THE PROJECT AND SITE SPECIFICALLY IDENTIFIED HEREIN. ANY UNAUTHORIZED REUSE, REPRODUCTION OR ALTERATION OF THIS DRAWING IS STRICTLY PROHIBITED. THE APPLICANT ACCEPTS FULL RESPONSIBILITY FOR THE ACCURACY OF THE INFORMATION PROVIDED TO THE ARCHITECT AND FOR THE COMPLETION OF THE PROJECT. THE ARCHITECT'S LIABILITY IS LIMITED TO THE DESIGN AND CONSTRUCTION OF THE STRUCTURE SHOWN AND FOR THE PROVISION OF SERVICES AS SPECIFIED IN THE CONTRACT. FINAL DESIGN TO BE AS STRUCTURAL ENGINEERS' DETAILS AND SPECIFICATIONS.

PROJECT
 LAND AT REAR OF PARK HOUSE, BRONCOED BUSINESS PARK for F. G. WHITLEY

DRAWING TITLE
 PLANNING - SITE LOCATION PLAN

SCALE 1 : 2000 @ A3
DATE 24/07/18
DRAWN MR
CHECKED SV

DRAWING STATUS PRELIMINARY

JOB No C892
DRAWING No 020
REVISION

AG|A AINSLEY COMMON ARCHITECTS

THE GAP HOUSE 15, NORTH ST, CLONMELLY, DUBLIN 15, IRELAND. TEL: 01204 517 883. WWW.AINSLEYCOMMONARCHITECTS.COM
 Ainsley Common Architects is a registered architectural practice in Ireland. Registered Architect: F. G. Whitley, Member of the Institute of Architects, Ireland.

PRINTED: 25/07/2018 15:13:51

A3